



LED NEON FLEX SPECIFICATION

IP67 3D SILICONE NEON 1010 24V



IP67 3D SILICONE NEON 1010 24V

LCE LED & COMPONENTS EXPERT

Regular power 5W/m, 10W/m

Max length 5 meters with one end power

Six CCT optional from 2700K to 6500K

Top bending and side bending in one NEON



Dimensions & Waterproof

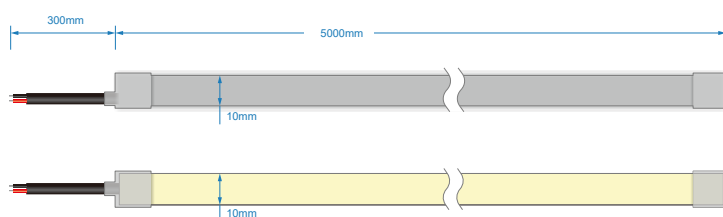

Note: Min bending diameter of Top bend>300mm, Min bending diameter of Side bend>400mm

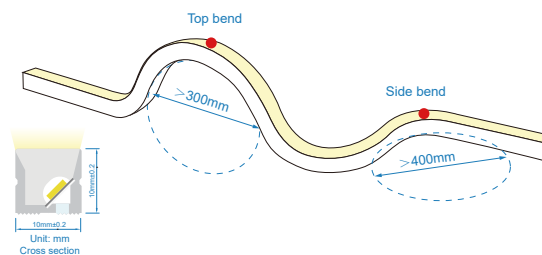

Electrical Parameter

Voltage	DC24V
LED PIN Temperature	Max. 65°C
Storage Temperature	-25°C~ 60°C
Ambient Temperature	Min.-25°C
CRI	>90

Specification

Power	Min:5W/M;Max:10W/M
Efficacy@4000K	50.6lm/w
Max Ambient Temperature	45°C

Due to the tolerance of the production and electrical components, output value and electrical power can vary up to 10%

Length Standard

Length Range (M)	Final Length		Tolerance
	Integral end cap	Silicone end cap	
0M<Neon Strip≤5M	L+6	L+8	±7

Single color parameters

CCT(K)	CRI	Voltage	Low power(5w/m)		High power(10w/m)		Unit Length (mm)	Max. Run Length (M)	CC/CV
			LM/M	LM/W	LM/M	LM/W			
2700K±150	≥90	DC24V	232	23.2	464	46.4	35.7	5	CV
3000K±150	≥90	DC24V	243	24.3	486	48.6	35.7	5	CV
3500K±200	≥90	DC24V	245.5	24.55	491	49.1	35.7	5	CV
4000 ⁺⁴⁰⁰ ₋₂₀₀	≥90	DC24V	253	25.3	506	50.6	35.7	5	CV
5000 ⁺⁵⁰⁰ ₋₃₀₀	≥90	DC24V	253	25.3	506	50.6	35.7	5	CV
6500 ⁺²⁰⁰ ₋₆₀₀	≥90	DC24V	246.5	24.65	493	49.3	35.7	5	CV
Red	--	DC24V	84	8.4	168	16.8	35.7	5	CV
Green	--	DC24V	222.5	22.25	445	44.5	35.7	5	CV
Blue	--	DC24V	47.5	4.75	95	9.5	35.7	5	CV
Yellow	--	DC24V	55	5.5	110	11.0	35.7	5	CV
Orange	--	DC24V	73.5	7.35	147	14.7	35.7	5	CV
Pink	--	DC24V	185.5	18.55	371	37.1	35.7	5	CV

- The maximum series length refers to the maximum single end power supply length of the constant current strip under the condition of standard 30cm wire.
- For the load capacity of the solder free end cap, please refer to <The Maximum Load Capacity of Power Cables>
- The given color temperature is the temperature of finished product.
- The given data are typical values due to the tolerances of the production process and the electrical components, values for light output and electrical power can vary up to 10%.
- All products can be dimmed; the dimmer's voltage should conform to the rated voltage of the led light. The output frequency of the dimmer of the constant-current led light should be less than 2K Hz, and the output PWM can control the led light.

Silicone end cap

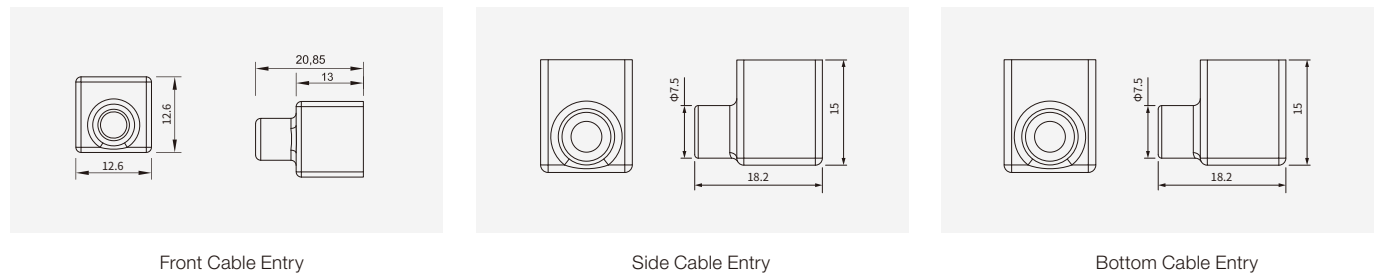

Cable

Cable Type	Schematic Diagram	Specification	Core	Electrical Properties
PVC Cable		OD: 4.0mm / Inner core: 20AWG		Red V+, Black V-
Waterproof Connector with PVC Cable		OD: 4.0mm /Inner core: 20AWG M12Male / Female connecto		Red V+, Black V-

Cutting Mark

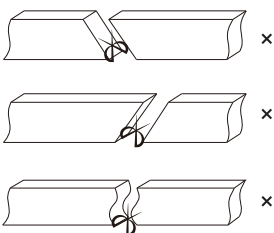

Remark:
The bottom of the led strip has transparent window, the black marker is the cutting position

Use professional scissors to cut vertically at the cutting mark

Please don't be feel free to cut and cut into an oblique angle or cambered section.

Mounting Way

Aluminium Profile

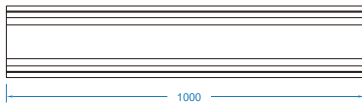
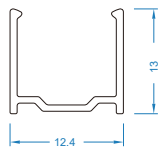

Dimension:
1000(±5)x12.4x13mm
Accessories:
Screw M3x15mm

transparent plastic groove

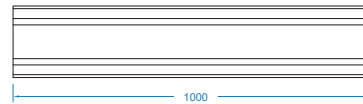
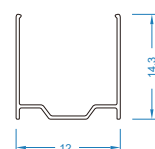

Dimension:
1000(±5)x12x14.3mm
Accessories:
Screw M3x15mm

Wiring diagram

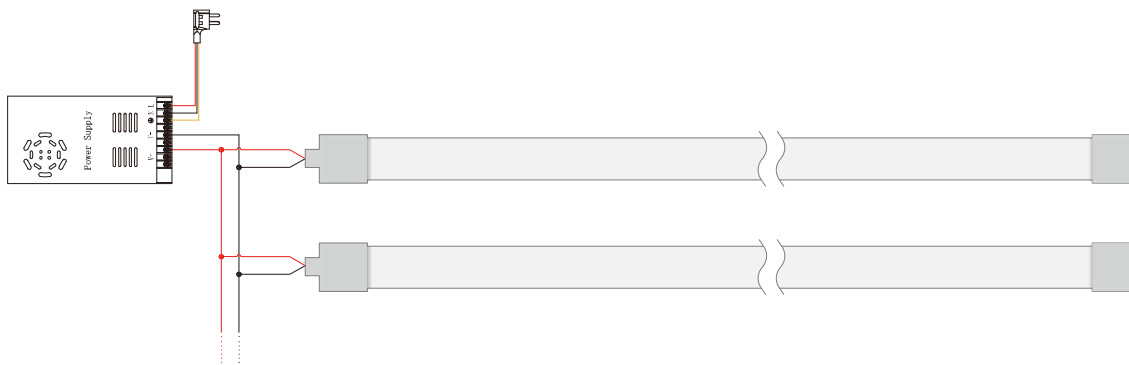

Installation Precautions

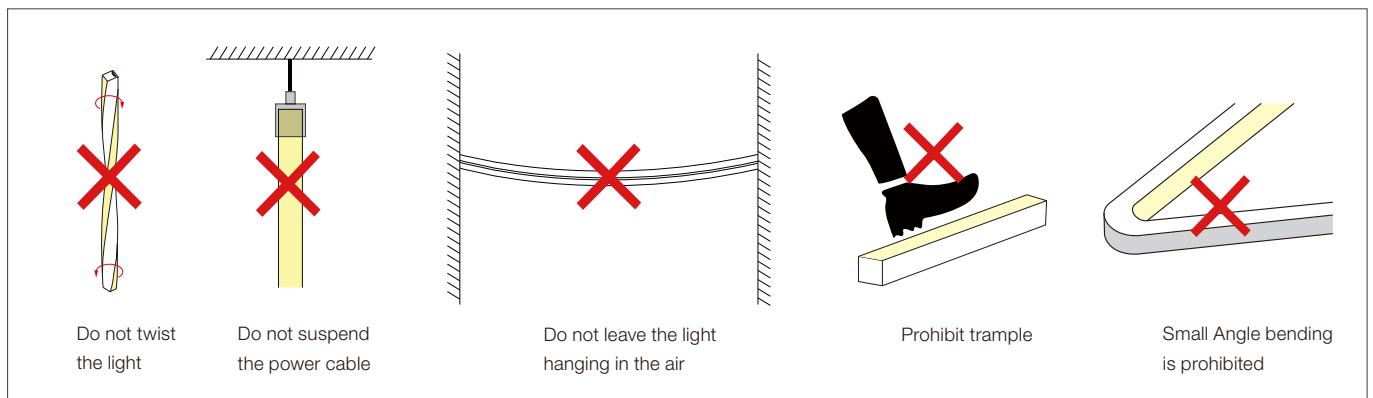
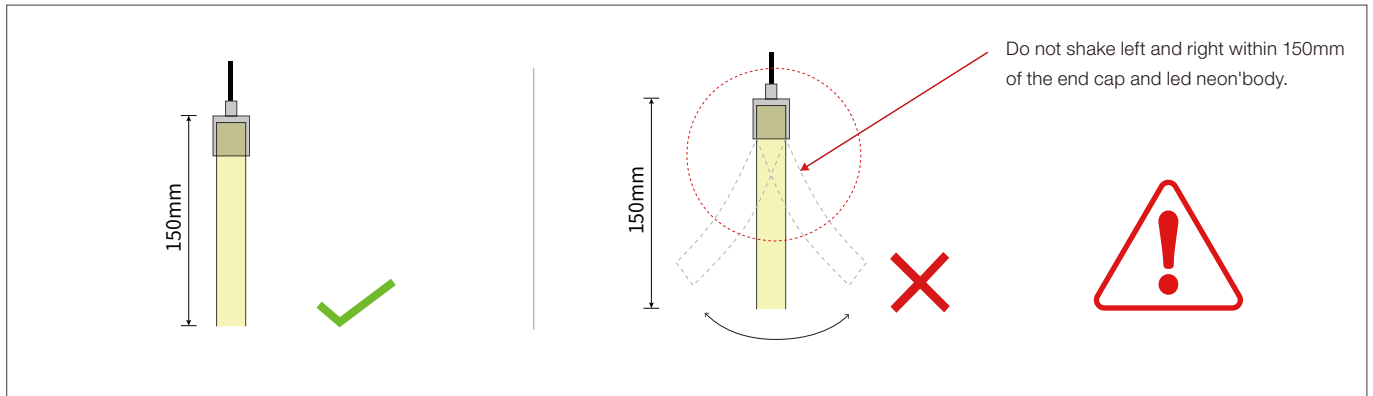

Put it in the profile

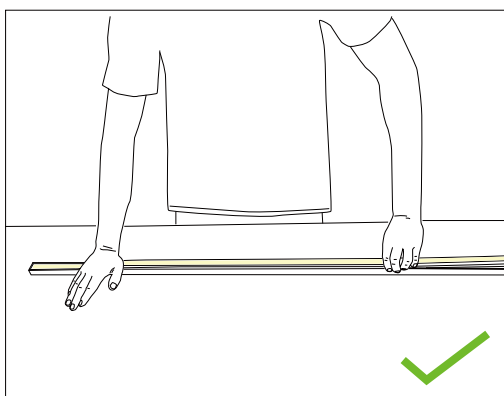

- Please press the led strip with your palm to slowly insert the led strip into the groove, and gently straighten the led strip above the groove with your right hand.
- Try to keep the led strip in a flat state during the installation process.

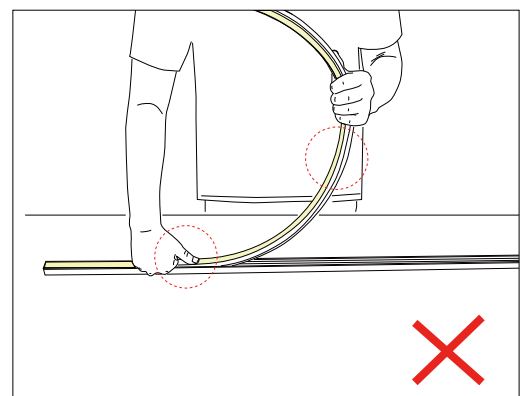

- Do not press the led strip with a single finger, it is easy to damage the internal parts of the led strip.
- The bent arc of the led strip should not be too large during installation.

Notes

The selection of the cable specification at the output end of the power supply, it depends on the total current of the load and the length of the cable. It is recommended to select according to the following table:

Current of the light	Specifications of the cable								
	L=1M	L=2M	L=4M	L=6M	L=8M	L=10M	L=12M	L=14M	L=16M
1A	AWG26	AWG23	AWG21	AWG18	AWG18	AWG17	AWG16	AWG15	AWG15
2A	AWG23	AWG21	AWG18	AWG16	AWG15	AWG14	AWG13	AWG12	AWG12
3A	AWG22	AWG18	AWG16	AWG14	AWG13	AWG12	AWG11	AWG11	AWG10
4A	AWG21	AWG18	AWG15	AWG13	AWG12	AWG11	AWG10	AWG9	AWG9
5A	AWG20	AWG17	AWG14	AWG12	AWG11	AWG10	AWG9	AWG9	AWG8
6A	AWG18	AWG16	AWG13	AWG11	AWG10	AWG9	AWG8	AWG8	AWG7
7A	AWG18	AWG15	AWG12	AWG11	AWG9	AWG8	AWG8	AWG7	AWG6
8A	AWG17	AWG15	AWG12	AWG10	AWG9	AWG8	AWG7	AWG7	AWG6
9A	AWG17	AWG14	AWG11	AWG10	AWG8	AWG7	AWG7	AWG6	AWG5
10A	AWG16	AWG14	AWG11	AWG9	AWG8	AWG7	AWG6	AWG6	AWG5

- ※ The unused light should be sealed with the packaging bag to avoid prolonged exposure.
- ※ Please use DC24V isolated constant voltage power supply with ripple voltage less than 5%. Using other types of power supply may damage the light or cause other safety risks.
- ※ In practical application, 20% allowance should be reserved for power supply to ensure the stability of power supply.
- ※ It is recommended that professionals connect the power supply. Do not connect the power supply with live power to avoid electric shock.
- ※ Please confirm whether the voltage of the power supply is consistent with the voltage of the light; Pay attention to the positive and negative poles of the power cord, do not connect wrong, so as not to cause product damage;
- ※ When multiple power supplies are used, ensure that the positive poles of the power supply are not connected in parallel. Otherwise, the power supply system may be unstable or damaged after long-term operation.
- ※ If the actual application length exceeds the specified length, it will lead to overload, heating and uneven brightness of the light.
- ※ During installation, please do not scratch, twist, or bend the light irregularly. Otherwise, the light may be damaged beyond repair.
- ※ To ensure the life and reliability of the light, please do not over bend the light, which will damage the product itself.
- ※ To protect your eyes, please avoid staring at the glowing surface of the light for a long time.
- ※ Non-professionals are forbidden to install, disassemble and maintain the product.
- ※ Do not use any acid or alkaline adhesive to fix the light (including but not limited to glass glue, etc.)
- ※ IP67 products are not suitable for long-term immersion in water; IP68 products are only customized by the factory. After cutting and processing by users themselves, there is a risk that IP68 protection level cannot be reached
- ※ Because of the difference in structure, even if the same color temperature value, different sizes of light will look slightly different colors. Please confirm it before use.

Tests showed that methanol and benzenes will have yellowing effects on silicone.

In the newly decorated interior environment, epoxy floor paint, wall paint, wallpaper adhesive, various decoration materials or new furniture, they are likely to release of methanol and benzenes.

It is recommended to remove methanol and benzenes first, or ventilate for a period of time in the newly decorated interior environment before install the silicone neon light, to avoid affecting the silicone body.